

# Totowa Borough Public Schools

10 Crews Street, Totowa, NJ 07512

Phone: 973-956-0010 Fax: 973-389-2270 E-Mail: Totowaluciano @Yahoo.com

---

*Patricia Capitelli*  
Chief School Administrator

*Jennifer Schweighardt*  
School Nurse

June 24, 2022

Dear Parents and Guardians:

If you will need medication to be administered by the school nurse during the 2022-2023 school year, **please have your physician fill out, sign and stamp the enclosed medication form**

**/forms.** A parent / guardian signature is also required on the medication form.

All medication, over the counter and prescribed, requires a doctor's order and signature.

Please return the form and medication to the school nurse.

All medication must be brought to school by a parent / guardian and be in its original container.

As always if you have any questions or concerns, please feel free to call the school nurse's office at extension 2200.

Sincerely,

Jennifer Schweighardt, RN, CSN

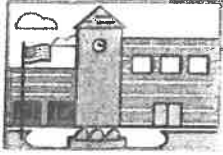

TOTOWA  
PUBLIC  
SCHOOLS

OFFICE OF THE SUPERINTENDENT  
Washington Park School  
10 Crews Street, Totowa, NJ 07512  
Phone: 973-956-0010

Patricia Capitelli

Superintendent

*Lori Johnson, Jennifer Schweighardt*  
School Nurses

**Permission Form for Administration of Medication  
2022-2023 School Year**

**Medication must come as dispensed by the pharmacy; have the name of the child, prescribing physician, medication, dosage, administration schedule, and the name of the pharmacy on the container. Parents are responsible for bringing the medication to the school and for picking up unused medication.**

**It should be understood that when the Parent(s)/Guardian(s) authorize a medical treatment for their child in school, such authorization includes permission for appropriate communication between the school health professional and the medical prescriber related to the specific treatment in question.**

Pupils Name \_\_\_\_\_  
 Name of Medication \_\_\_\_\_  
 Purpose of its administration to pupil \_\_\_\_\_  
 Proper Timing of Medication \_\_\_\_\_  
 Proper dosage of medication: \_\_\_\_\_  
 Possible side effects: \_\_\_\_\_  
 Other medication(s) currently being taken: \_\_\_\_\_  
 Time Medication will be discontinued: End of current school year. (2022-2023)

**The above student is physically fit to attend school, free of contagious disease, and would not be able to attend school unless the above medication can be administered during school time.**

Physician Signature: \_\_\_\_\_ Date: \_\_\_\_\_

Physician's Name (print) \_\_\_\_\_

Parent/ Guardian  
 Signature \_\_\_\_\_ Date: \_\_\_\_\_

Permission Granted: \_\_\_\_\_ Principal's Signature: \_\_\_\_\_ Date: \_\_\_\_\_

Permission Denied: \_\_\_\_\_ Principal's Signature: \_\_\_\_\_

Reason for Denial: \_\_\_\_\_

All discontinued medication must be picked up by the parent within two weeks or it will be discarded.

**\*\*The parents or guardians of the pupil acknowledge that the Totowa school district, the Board of Education, and its employees shall incur no liability as a result of any injury arising from the administration of medication by the school nurse. Also the parents or guardians shall indemnify and hold harmless the Totowa School district, the Board of Education and its employees or agents from any and all claims arising out of the administration of medication.**

Revised 6/2023



Name: \_\_\_\_\_ D.O.B.: \_\_\_\_\_

Allergy to: \_\_\_\_\_

Weight: \_\_\_\_\_ lbs. Asthma:  Yes (higher risk for a severe reaction)  No

PLACE  
PICTURE  
HERE

**NOTE: Do not depend on antihistamines or inhalers (bronchodilators) to treat a severe reaction. USE EPINEPHRINE.**

**Extremely reactive to the following allergens:** \_\_\_\_\_

THEREFORE:

If checked, give epinephrine immediately if the allergen was **LIKELY** eaten, for ANY symptoms.

If checked, give epinephrine immediately if the allergen was **DEFINITELY** eaten, even if no symptoms are apparent.

## FOR ANY OF THE FOLLOWING: SEVERE SYMPTOMS



### LUNG

Shortness of breath, wheezing, repetitive cough



### HEART

Pale or bluish skin, faintness, weak pulse, dizziness



### THROAT

Tight or hoarse throat, trouble breathing or swallowing



### MOUTH

Significant swelling of the tongue or lips



### SKIN

Many hives over body, widespread redness



### GUT

Repetitive vomiting, severe diarrhea



### OTHER

Feeling something bad is about to happen, anxiety, confusion

**OR A COMBINATION**  
of symptoms from different body areas.



- 1. INJECT EPINEPHRINE IMMEDIATELY.**
- 2. Call 911.** Tell emergency dispatcher the person is having anaphylaxis and may need epinephrine when emergency responders arrive.
  - Consider giving additional medications following epinephrine:
    - » Antihistamine
    - » Inhaler (bronchodilator) if wheezing
  - Lay the person flat, raise legs and keep warm. If breathing is difficult or they are vomiting, let them sit up or lie on their side.
  - If symptoms do not improve, or symptoms return, more doses of epinephrine can be given about 5 minutes or more after the last dose.
  - Alert emergency contacts.
  - Transport patient to ER, even if symptoms resolve. Patient should remain in ER for at least 4 hours because symptoms may return.

## MILD SYMPTOMS



### NOSE

Itchy or runny nose, sneezing



### MOUTH

Itchy mouth



### SKIN

A few hives, mild itch



### GUT

Mild nausea or discomfort

**FOR MILD SYMPTOMS FROM MORE THAN ONE SYSTEM AREA, GIVE EPINEPHRINE.**

**FOR MILD SYMPTOMS FROM A SINGLE SYSTEM AREA, FOLLOW THE DIRECTIONS BELOW:**

- Antihistamines may be given, if ordered by a healthcare provider.
- Stay with the person; alert emergency contacts.
- Watch closely for changes. If symptoms worsen, give epinephrine.

## MEDICATIONS/DOSES

Epinephrine Brand or Generic: \_\_\_\_\_

Epinephrine Dose:  0.15 mg IM  0.3 mg IM

Antihistamine Brand or Generic: \_\_\_\_\_

Antihistamine Dose: \_\_\_\_\_

Other (e.g., inhaler-bronchodilator if wheezing): \_\_\_\_\_



### HOW TO USE AUVI-Q® (EPINEPHRINE INJECTION, USP), KALEO

1. Remove Auvi-Q from the outer case.
2. Pull off red safety guard.
3. Place black end of Auvi-Q against the middle of the outer thigh.
4. Press firmly, and hold in place for 5 seconds.
5. Call 911 and get emergency medical help right away.

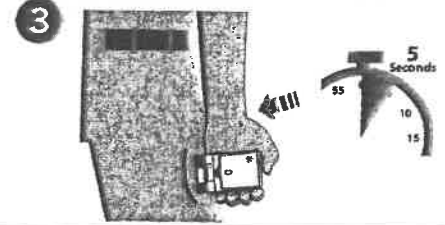

### HOW TO USE EPIPEN® AND EPIPEN JR® (EPINEPHRINE) AUTO-INJECTOR, MYLAN

1. Remove the EpiPen® or EpiPen Jr® Auto-Injector from the clear carrier tube.
2. Grasp the auto-injector in your fist with the orange tip (needle end) pointing downward.
3. With your other hand, remove the blue safety release by pulling straight up.
4. Swing and push the auto-injector firmly into the middle of the outer thigh until it 'clicks'.
5. Hold firmly in place for 3 seconds (count slowly 1, 2, 3).
6. Remove and massage the injection area for 10 seconds.
7. Call 911 and get emergency medical help right away.

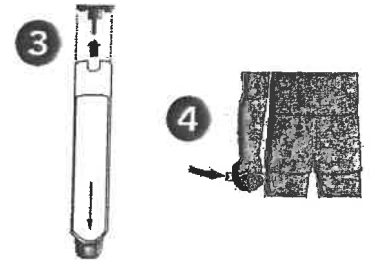

### HOW TO USE EPINEPHRINE INJECTION (AUTHORIZED GENERIC OF EPIPEN®), USP AUTO-INJECTOR, MYLAN

1. Remove the epinephrine auto-injector from the clear carrier tube.
2. Grasp the auto-injector in your fist with the orange tip (needle end) pointing downward.
3. With your other hand, remove the blue safety release by pulling straight up.
4. Swing and push the auto-injector firmly into the middle of the outer thigh until it 'clicks'.
5. Hold firmly in place for 3 seconds (count slowly 1, 2, 3).
6. Remove and massage the injection area for 10 seconds.
7. Call 911 and get emergency medical help right away.

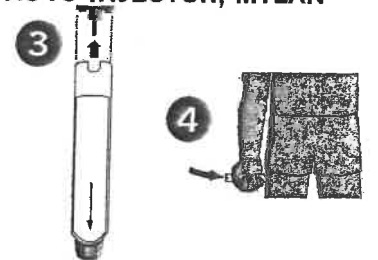

### HOW TO USE IMPAX EPINEPHRINE INJECTION (AUTHORIZED GENERIC OF ADRENALICK®), USP AUTO-INJECTOR, IMPAX LABORATORIES

1. Remove epinephrine auto-injector from its protective carrying case.
2. Pull off both blue end caps: you will now see a red tip.
3. Grasp the auto-injector in your fist with the red tip pointing downward.
4. Put the red tip against the middle of the outer thigh at a 90-degree angle, perpendicular to the thigh.
5. Press down hard and hold firmly against the thigh for approximately 10 seconds.
6. Remove and massage the area for 10 seconds.
7. Call 911 and get emergency medical help right away.

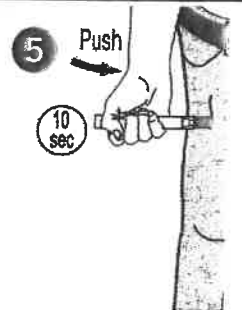

### ADMINISTRATION AND SAFETY INFORMATION FOR ALL AUTO-INJECTORS:

1. Do not put your thumb, fingers or hand over the tip of the auto-injector or inject into any body part other than mid-outer thigh. In case of accidental injection, go immediately to the nearest emergency room.
2. If administering to a young child, hold their leg firmly in place before and during injection to prevent injuries.
3. Epinephrine can be injected through clothing if needed.
4. Call 911 immediately after injection.

### OTHER DIRECTIONS/INFORMATION (may self-carry epinephrine, may self-administer epinephrine, etc.):

Treat the person before calling emergency contacts. The first signs of a reaction can be mild, but symptoms can worsen quickly.

#### EMERGENCY CONTACTS — CALL 911

RESCUE SQUAD: \_\_\_\_\_  
 DOCTOR: \_\_\_\_\_ PHONE: \_\_\_\_\_  
 PARENT/GUARDIAN: \_\_\_\_\_ PHONE: \_\_\_\_\_

#### OTHER EMERGENCY CONTACTS

NAME/RELATIONSHIP: \_\_\_\_\_  
 PHONE: \_\_\_\_\_  
 NAME/RELATIONSHIP: \_\_\_\_\_  
 PHONE: \_\_\_\_\_



# Asthma Treatment Plan – Student Parent Instructions



The **PACNJ Asthma Treatment Plan** is designed to help everyone understand the steps necessary for the individual student to achieve the goal of controlled asthma.

- 1. Parents/Guardians:** *Before taking this form to your Health Care Provider, complete the top left section with:*
  - Child's name
  - Child's doctor's name & phone number
  - Parent/Guardian's name & phone number
  - Child's date of birth
  - An Emergency Contact person's name & phone number
- 2. Your Health Care Provider will complete the following areas:**
  - The effective date of this plan
  - The medicine information for the Healthy, Caution and Emergency sections
  - Your Health Care Provider will check the box next to the medication and check how much and how often to take it
  - Your Health Care Provider may check **"OTHER" and:**
    - ❖ Write in asthma medications not listed on the form
    - ❖ Write in additional medications that will control your asthma
    - ❖ Write in generic medications in place of the name brand on the form
  - Together you and your Health Care Provider will decide what asthma treatment is best for your child to follow
- 3. Parents/Guardians & Health Care Providers together** will discuss and then complete the following areas:
  - Child's peak flow range in the Healthy, Caution and Emergency sections on the left side of the form
  - Child's asthma triggers on the right side of the form
  - Permission to Self-administer Medication section at the bottom of the form: Discuss your child's ability to self-administer the inhaled medications, check the appropriate box, and then both you and your Health Care Provider must sign and date the form
- 4. Parents/Guardians:** *After completing the form with your Health Care Provider:*
  - Make copies of the Asthma Treatment Plan and give the signed original to your child's school nurse or child care provider
  - Keep a copy easily available at home to help manage your child's asthma
  - Give copies of the Asthma Treatment Plan to everyone who provides care for your child, for example: babysitters, before/after school program staff, coaches, scout leaders

## PARENT AUTHORIZATION

I hereby give permission for my child to receive medication at school as prescribed in the Asthma Treatment Plan. Medication must be provided in its original prescription container properly labeled by a pharmacist or physician. I also give permission for the release and exchange of information between the school nurse and my child's health care provider concerning my child's health and medications. In addition, I understand that this information will be shared with school staff on a need to know basis.

\_\_\_\_\_  
Parent/Guardian Signature

\_\_\_\_\_  
Phone

\_\_\_\_\_  
Date

## FILL OUT THE SECTION BELOW ONLY IF YOUR HEALTH CARE PROVIDER CHECKED PERMISSION FOR YOUR CHILD TO SELF-ADMINISTER ASTHMA MEDICATION ON THE FRONT OF THIS FORM.

**RECOMMENDATIONS ARE EFFECTIVE FOR ONE (1) SCHOOL YEAR ONLY AND MUST BE RENEWED ANNUALLY**

- I do request that my child be **ALLOWED** to carry the following medication \_\_\_\_\_ for self-administration in school pursuant to N.J.A.C.:6A-16-2.3. I give permission for my child to self-administer medication, as prescribed in this Asthma Treatment Plan for the current school year as I consider him/her to be responsible and capable of transporting, storing and self-administration of the medication. Medication must be kept in its original prescription container. I understand that the school district, agents and its employees shall incur no liability as a result of any condition or injury arising from the self-administration by the student of the medication prescribed on this form. I indemnify and hold harmless the School District, its agents and employees against any claims arising out of self-administration or lack of administration of this medication by the student.
- I **DO NOT** request that my child self-administer his/her asthma medication.

\_\_\_\_\_  
Parent/Guardian Signature

\_\_\_\_\_  
Phone

\_\_\_\_\_  
Date

